

Beam & Block Ventilation Detail

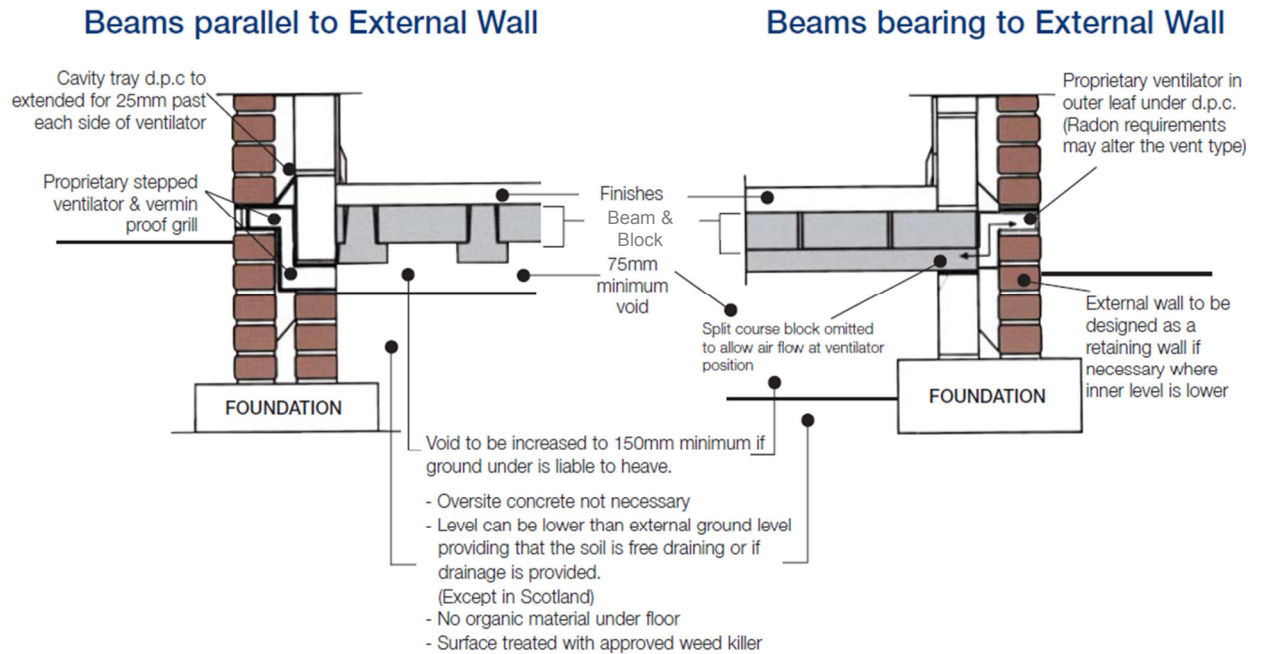

Ventilation

Ventilation must be provided to the void beneath the floor by openings in all external walls at not more than 3m centres. This gives a minimum open area per meter run of wall of 600mm². In areas where there might be landfill gas or methane contamination the minimum area of opening is 1500mm² per meter run of wall or 500mm² per square meter of floor area. Whichever is the greater should be used.

(In areas where full radon precautions are taken the minimum open area of 1500mm² per meter run should be used).